

TECH SHEET

FACE TILED WALL (SOLID WALL)

V2 LOW PROFILE BASE

build better™
DIRTT

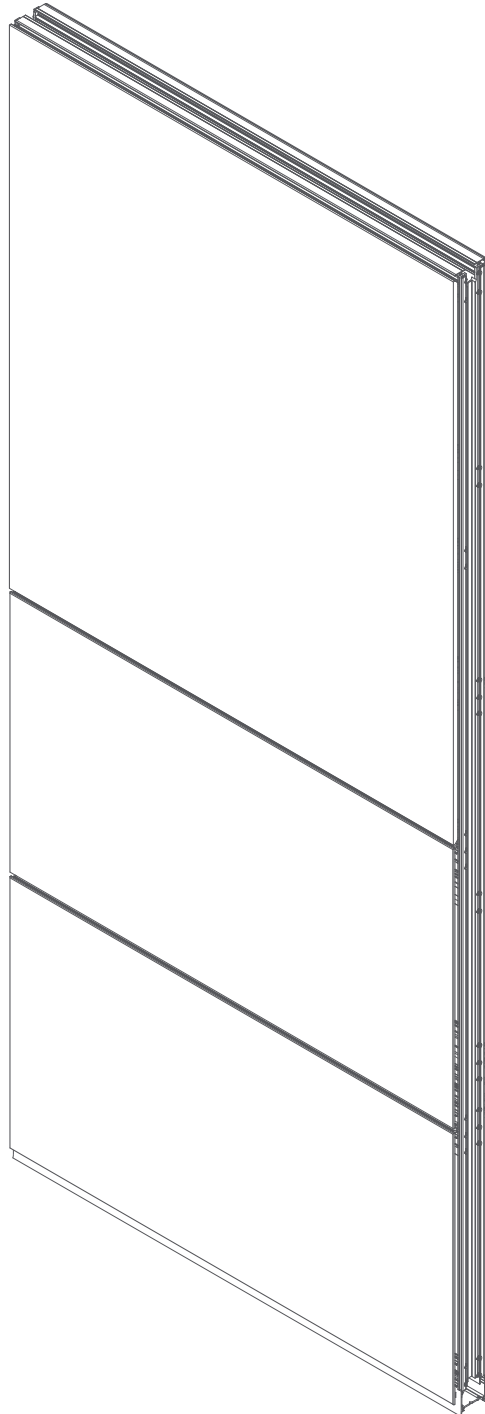

COMPONENTS & MATERIALS

ALUMINUM EXTRUSIONS

Architectural Grade and Structural Aluminum Alloys
Vertical & Horizontal Extrusions, Base Track

HORIZONTAL SECTIONS

Partially exposed Horizontal Support Member for dividing tiles and hanging components; heights user defined.
Hidden Horizontal Member for additional support of face mounted tiles; heights user defined as required.

INSULATION

1" (25mm) thick Insulation, factory installed in frame. Base Insulation to be field installed in base cavity prior to base trim or scribed tiles.

BASE TRACK

Aluminum Base Track
Steel Leveler Assembly with vertical adjustment
Carpet Grippers
Optional Two Sided Tape for smooth flooring
Optional Seismic Base Track

BASE TRIM

Santoprene Base Trim
Oversized Solid Tiles scribed to floor on site
Optional V1 Base with Aluminum Trim

FACE MOUNT TILE OPTIONS

Chromacoat (painted) Tiles
Wood Veneer on MDF Tiles
Willow® Glass on MDF Tiles
Micro Perforated Wood Veneer on MDF Tiles
Magnetic Marker Board Tiles
Marker Board Tiles
Fabric Tiles; tackable and non-tackable
Frameless Back Painted Glass Tiles
Slat Wall Tiles (Accessory Rail)
DIRTT Approved Custom Finishes

PVC COMPONENTS

Frame Connections	Rigid/Flex Co-extrusion
Ceiling Trim/Wall Start	Rigid/Flex Co-extrusion
PVC Color Options	Black ,Charcoal, Silver, Custom as required

ELECTRICAL COMPONENTS

120 / 208V 20A (15A Canada)	
Maximum of 30 Wall Boxes per Frame	
UL/CSA Listed Wall Boxes and Devices	
Level 3 Wall Boxes	UL/CSA Listed AC/MC Cable
Level 4 Wall Boxes	Connect to Splitters, Extender Cables, Express Lines, Whips, Zone Boxes in Ceiling or Wall

DIMENSIONS & DETAILS

FRAME

Standard Wall Thickness	4" (102mm) with Tiles
Minimum Module Width	6" (152mm)
Maximum Module Width	48" (1219mm)
Standard Ceiling Height	Up to 144" (3658mm)
Vertical Height Adjustment	

V2 Base $-3/8"$ (-9.5mm) and $+2 5/8"$ (+67mm)

**Frame assemblies exceeding 48" (1219mm) in width or 144" (3658mm) in height, or both must be validated by DIRTT to confirm walls do not exceed the maximum allowable deflection per IBC.*

FRAME CONNECTIONS

Hidden Links	Frame alignment and gap control
Visible PVC Zipper	At frame connection between frames

TRIM COMPONENTS

Ceiling Trim	Flexible trim from top of wall to ceiling
Wall Trim	Rigid connection from Frame to Base Building; combined with flexible Wall Trim

OTHER COMPONENT CONNECTIONS TO SOLID WALLS

Glass Panels
Door Frames
Corner Connectors
Various Base Building Connections
Modular Electrical
Conventional Electrical

OTHER OPTIONS

Combination Wall	Combined Face Tile Wall with Glass Wall
Curtain Wall	Installed in front of Base Building Wall Tiled one side only

Low Wall
Cornice Height Wall
Center Steel Septum
Mitered Corner Joint
Extended Levelers for additional leveling capability
Seismic
Enhanced STC Performance
DIRTT Approved Custom Solutions (Bespoke)
NAUF/NAF MDF
Fire Retardant MDF

TESTING & APPROVALS

Code Compliance Research Report	CCRR-1012
Transverse Load	ASTM E72
Flame Spread	ASTM E84
STC Rating 37-50 (Dependent on wall construction)	ASTM E90
Wall Electrical	UL 468975 (Sections & Units)
OSHPD	OPM-0044-13
Seismic Engineering Calculations	
Seismic Bracing Details	

Testing Reports, Details and Approvals are available upon request.

ISOMETRIC/WALL STRUCTURE

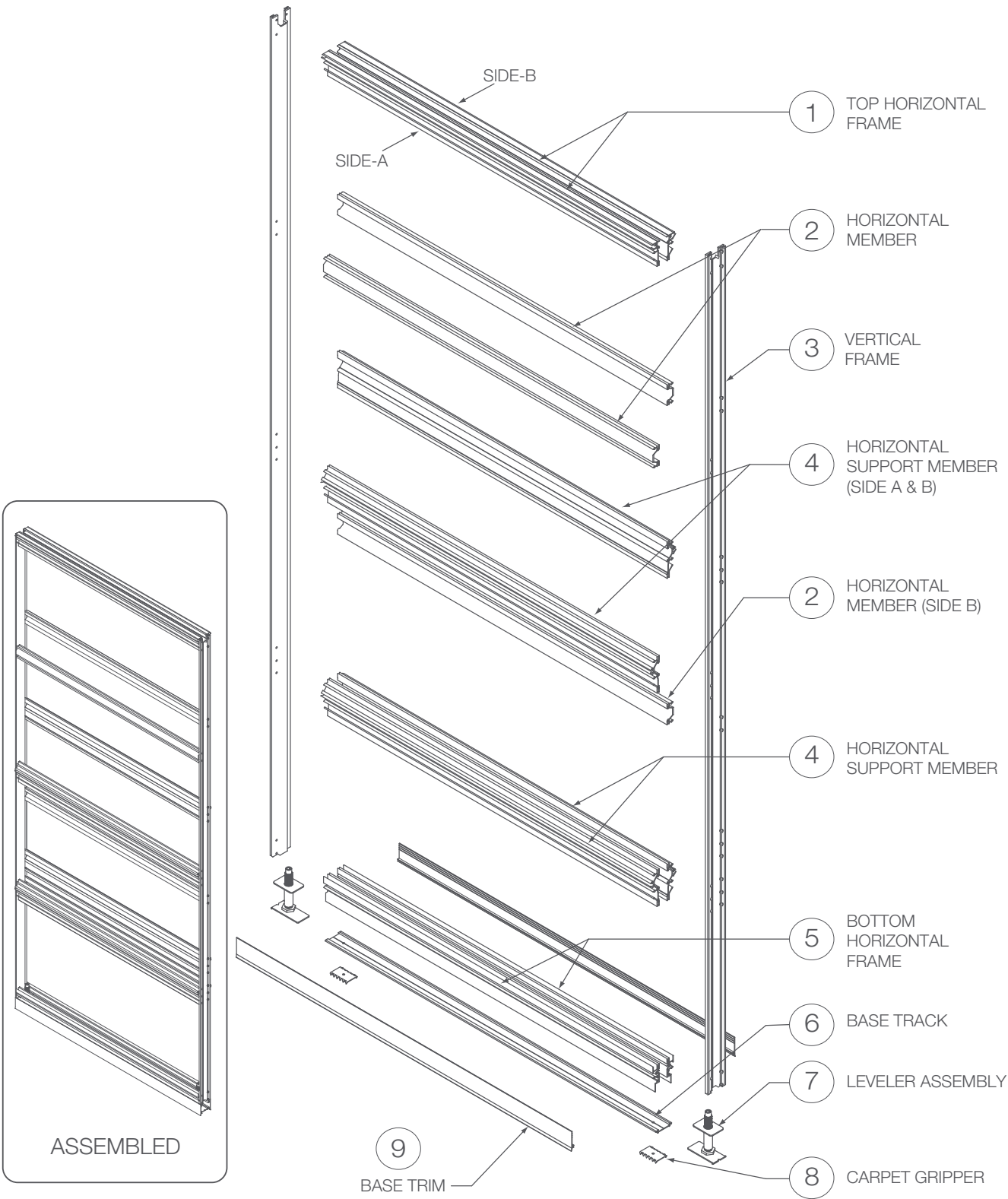

ISOMETRIC / WALL PANEL

